

Divator Accessory Rail Installation Instructions

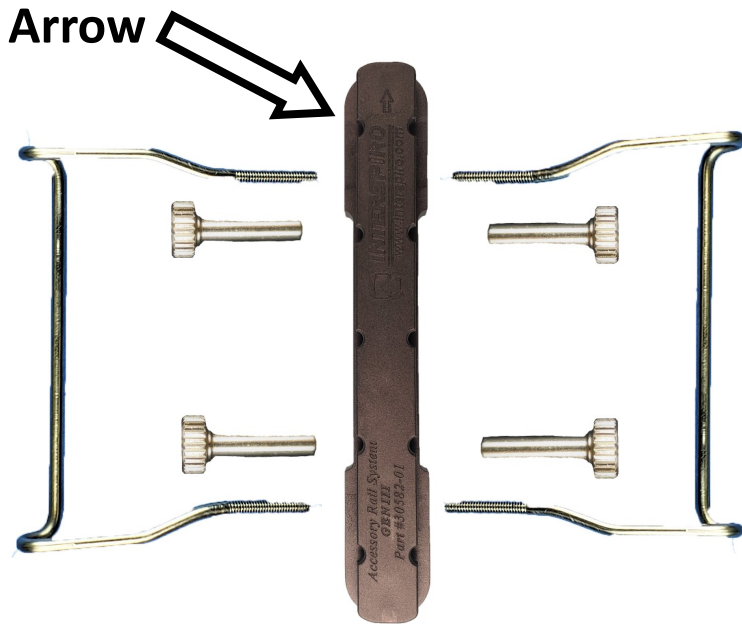

The wire mounts Pass through the Accessory Rails from either side. Please take note of the “Arrow” and be sure that when using Rails on both sides of the mask , they are **both** up or down.

The Accessory Rail should be mounted so it is parallel with the visor (see Pic 1) .Due to slight variations in masks, and different versions of the visor frame, it may be necessary to place the arrow in either the up, or down position. Use the position that aligns best with the visor. After inserting the Wire Mount into the Accessory Rail place the Thumb Screws on the end of the Wire Mount and screw them on one or two turns. The bent over portion of the Wire Mount captures the lip on the front of the visor (see Pic 2). The two lugs on the back of the Accessory Rail engage behind visor frame (see Pic 3). Tighten Thumb Screws by hand (**NO TOOLS**) while maintaining the Accessory Rail parallel with the visor.

